

Exploded View / Parts List

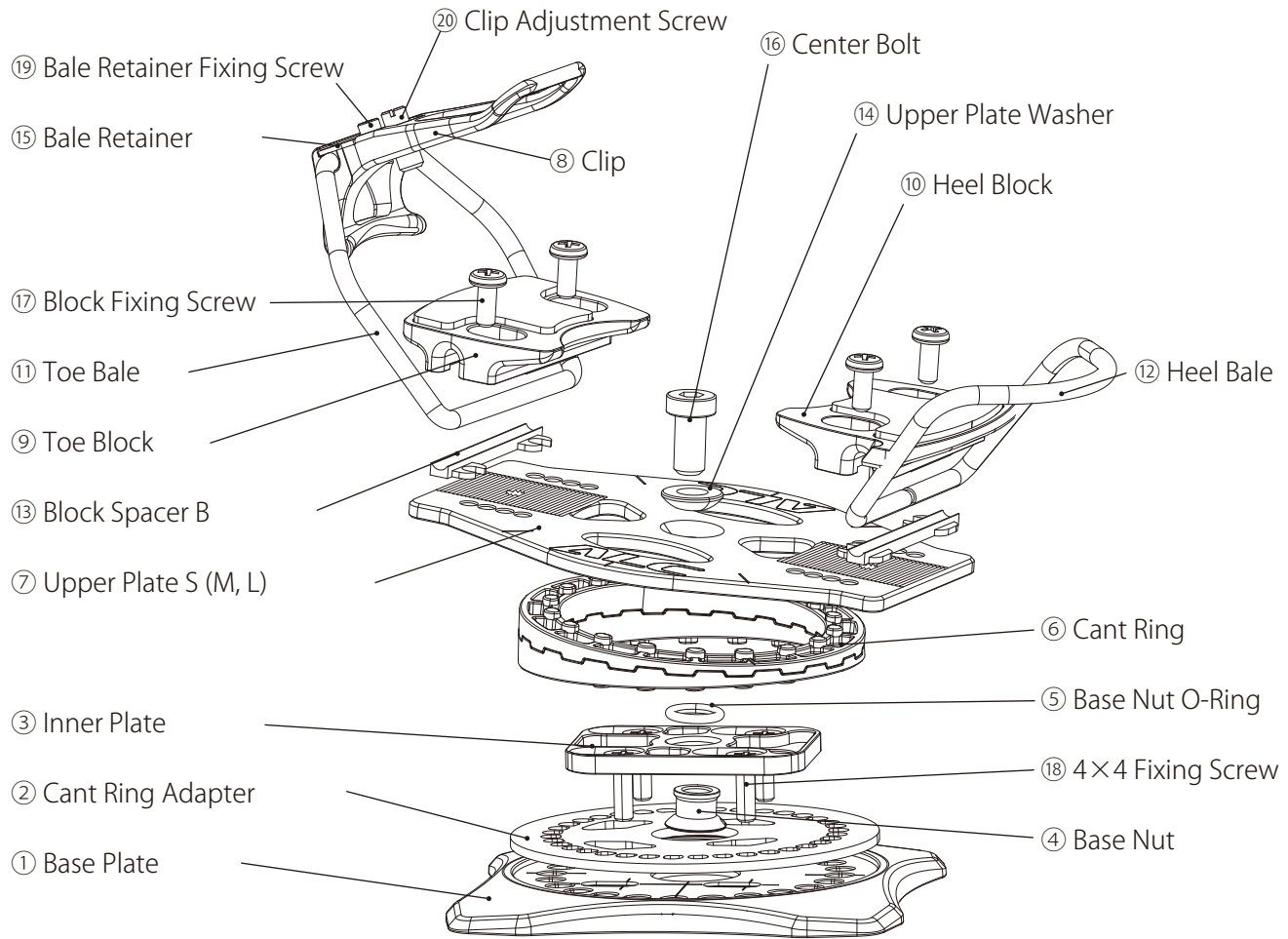

Part No./Part Name	Quantity	
① Base Plate	2	
② Cant Ring Adapter	2	
③ Inner Plate	2	
④ Base Nut	2	
⑤ Base Nut O-Ring	2	
⑥ Cant Ring	4	
⑦ Upper Plate	2	
⑧ Clip	2	
⑨ Toe Block	2	Block Rubber Bonded
⑩ Heel Block	2	Block Rubber Bonded
⑪ Toe Bale	2	
⑫ Heel Bale	2	
⑬ Block Spacer B	4	
⑭ Upper Plate Washer	2	
⑮ Bale Retainer	2	
⑯ Center Bolt	2	SUS Low Head Cap Screw M10×20 (L-Wrench 6mm)
⑰ Block Fixing Screw	8	SUS Binding-head Screw M6×14
⑱ 4×4 Fixing Screw	8	SUS Countersunk Screw M6×22
⑲ Bale Retainer Fixing Screw	2	SUS Cap Screw M4×6
⑳ Clip Adjustment Screw	2	Plastic M8×20

Mounting Instructions

1)

Place the Cant Ring Adapter and the Inner Plate on the Base Plate.

Align the orientation so that the holes on the Base Plate are visible through the Inner Plate.

2)

Temporarily attach the assembly to the board using the mounting screws.

At this stage, lightly tighten the screws so that the Cant Ring Adapter can still rotate.

3)

Stack the two Cant Rings so that the ridges and grooves interlock properly.

The alignment line where the numbers match indicates the peak of the combined rings.

The resulting tilt angle when stacked is as follows:

0 → 0.0° 1 → 1.4° 2 → 2.7° 3 → 4.0° 4 → 5.1°
5 → 6.1° 6 → 6.9° 7 → 7.5° 8 → 7.9° 9 → 8.0°

(These values are also printed on the top surface of the base plate.)

4)

Insert the stacked Cant Rings into the back side of the Upper Plate.

Adjust the peak direction of the Cant Rings according to your preferred setup.

The Cant Rings can be rotated in 10° increments relative to the Upper Plate.

Please refer to the chart below for how toe-up, heel-up, and canting angles relate to Cant Ring angles.

If you're unsure of your preferred settings or are new to alpine boards, try starting with toe-up on the front foot and heel-up on the rear foot.

5)

Place the Upper Plate with the Cant Ring set onto the Base Plate.

Make sure the boss (protrusion) on the Cant Ring fits into the hole (indentation) of the Cant Ring Adapter.

Rotate the Upper Plate to adjust the angle by shifting the Cant Ring Adapter accordingly.

6)

Remove everything above the Cant Rings and firmly tighten the 4×4 mounting screws.

7)

Use the included 6mm L-wrench to securely tighten the Center Bolt.

8)

Install the separate Clip Adjustment Screw onto the Clip.

Adjust its position while fitting it to your actual boot.

			Cant Ring Combination Angles										
			(Top Row: Combination Number / Bottom Row: Actual Tilt Angle)										
			0 0.000	1 1.391	2 2.740	3 4.005	4 5.147	5 6.132	6 6.931	7 7.519	8 7.879	9 8.000	
Cant Ring Peak Position (0° at Toe-Heel Direction)	0°	Lift/Cant	0.0/0.0	1.4/0.0	2.7/0.0	4.0/0.0	5.1/0.0	6.1/0.0	6.9/0.0	7.5/0.0	7.9/0.0	8.0/0.0	0°
	10°	Lift/Cant	0.0/0.0	1.4/0.2	2.7/0.5	3.9/0.7	5.1/0.9	6.0/1.1	6.8/1.2	7.4/1.3	7.8/1.4	7.9/1.4	10°
	20°	Lift/Cant	0.0/0.0	1.3/0.5	2.6/0.9	3.8/1.4	4.8/1.8	5.8/2.1	6.5/2.4	7.1/2.6	7.4/2.7	7.5/2.7	20°
	30°	Lift/Cant	0.0/0.0	1.2/0.7	2.4/1.4	3.5/2.0	4.5/2.6	5.3/3.1	6.0/3.5	6.5/3.8	6.8/3.9	6.9/4.0	30°
	40°	Lift/Cant	0.0/0.0	1.1/0.9	2.1/1.8	3.1/2.6	3.9/3.3	4.7/3.9	5.3/4.5	5.8/4.8	6.0/5.1	6.1/5.1	40°
	50°	Lift/Cant	0.0/0.0	0.9/1.1	1.8/2.1	2.6/3.1	3.3/3.9	3.9/4.7	4.5/5.3	4.8/5.8	5.1/6.0	5.1/6.1	50°
	60°	Lift/Cant	0.0/0.0	0.7/1.2	1.4/2.4	2.0/3.5	2.6/4.5	3.1/5.3	3.5/6.0	3.8/6.5	3.9/6.8	4.0/6.9	60°
	70°	Lift/Cant	0.0/0.0	0.5/1.3	0.9/2.6	1.4/3.8	1.8/4.8	2.1/5.8	2.4/6.5	2.6/7.1	2.7/7.4	2.7/7.5	70°
	80°	Lift/Cant	0.0/0.0	0.2/1.4	0.5/2.7	0.7/3.9	0.9/5.1	1.1/6.0	1.2/6.8	1.3/7.4	1.4/7.8	1.4/7.9	80°
	90°	Lift/Cant	0.0/0.0	0.0/1.4	0.0/2.7	0.0/4.0	0.0/5.1	0.0/6.1	0.0/6.9	0.0/7.5	0.0/7.9	0.0/8.0	90°

! Important Safety Instructions !

Please Read Before Using This Product

- ⚠ When using this product, please pay careful attention to the following precautions.
If any damage is found on the product or its components, or if you notice any unusual feeling during use, stop using it immediately and contact the dealer where you purchased it or our company directly.
- ⚠ Please use only the specified sizes for screws such as the 4×4 fixing screws, block fixing screws, and center bolt.
Using screws that are too short may lead to damage and pose a safety hazard.
- ⚠ Ensure that the 4×4 fixing screws are tightened securely.
If they are loose, the upper plate may rotate during use.
- ⚠ Be sure to tighten the center bolt after the 4×4 fixing screws have been securely fastened.
Tightening the 4×4 screws after the center bolt has already been secured is dangerous.
- ⚠ When installing this product directly onto the snowboard, always use the included base plate (resin).
Failure to use the base plate may result in damage to the snowboard.
- ⚠ If the product will not be used for an extended period, such as after the season ends, please either loosen all screws or store the product disassembled.

Warranty Certificate

Date of Purchase / /	Warranty Period: One year from the date of purchase
Name	
Address	
Model ALC-BN-64	
Dealer Stamp (販売店印)	Manufacturer / Distributor Avan Co., Ltd. ALC Snowboard Division 2515-5 Ontakado, Ueda-shi, Nagano 386-0412, Japan TEL : 0268-75-5760 FAX : 0268-75-5767